

ALTAIR



18/11 Starcevich Crescent Jacka ACT

2 2 2

This north facing property presents an excellent opportunity for those looking to enter the market in this highly desirable area of Jacka. The well-lit interiors and contemporary design are complemented by its distinctive location close to Amaroo shops, Amaroo school, Gungahlin Marketplace, & numerous walking paths that wind through the neighbourhood, offering a convenient lifestyle close to nature.

The home is thoughtfully designed to emphasize open-plan living, creating a spacious feel with 96m² of living space while maintaining versatility in the living areas. Ample natural light fills the entire home, with sizable windows on both sides, ensuring a comfortable living environment.

Type : Townhouse
Building Size : 96 sqm
View : <https://www.altairproperty.com.au/sale/act/gungahlin/jacka/residential/townhouse/7818296>



Rahul Mehta
0404 895 162

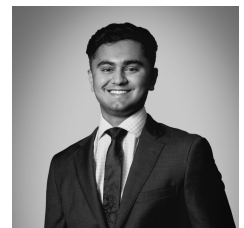

Arjun Choudhary
0404 895 162

[For full version visit the website](https://www.altairproperty.com.au)

<https://www.altairproperty.com.au>

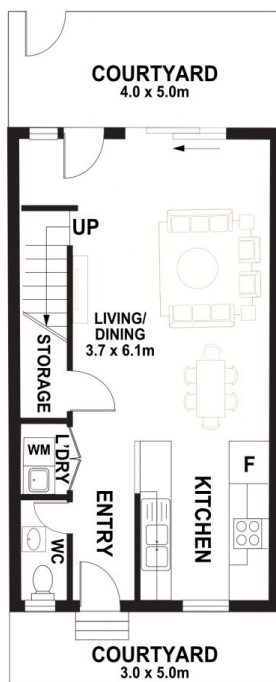

GROUND FLOOR

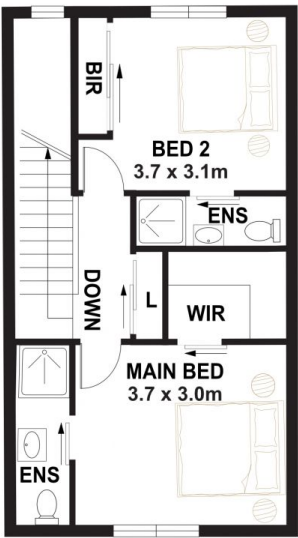

FIRST FLOOR

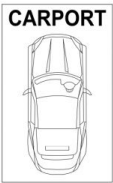

PLANS SHOWN ARE FOR MARKETING PURPOSES ONLY. ALL DIMENSIONS ARE APPROXIMATE AND NOT TO SCALE. THEY ARE SUBJECT TO ERRORS AND INACCURACIES AND NO LIABILITY WILL BE ACCEPTED. INTERESTED PARTIES SHOULD MAKE THEIR OWN ENQUIRIES.

18/11 STARCEVICH CRESCENT, JACKA