

ALTAIR



51 Dorrie Crescent Moncrieff ACT

4 2 2

PLEASE NOTE: This property is going to auction on 14/9/2024 at 2:00pm (on site) if not sold prior.

Welcome to 51 Dorrie Crescent, Moncrieff, a beautifully designed single-level home that offers an ideal combination of modern comfort and a practical floor plan. Centrally located, this property enjoys convenient access to Horse Park Drive, Casey Market Town and the Gungahlin Town Centre, as well as a number of local schools and parks, making it an ideal choice for families and professionals alike. With no stairs, this home is suitable for buyers of all ages, offering a seamless and practical layout that maximises space.

The home features four generous bedrooms, all with built-in robes, and two well-appointed bathrooms. The segregated master suite is impressive, complete with a

Building Size : 222 sqm
View : <https://www.altairproperty.com.au/sale/act/gungahlin/moncrieff/residential/house/8104745>



Andrew Potts
0404 895 162



FLOOR PLAN

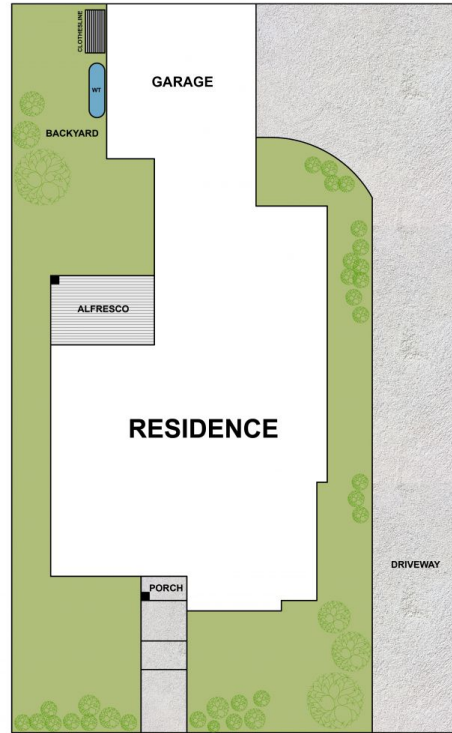

SITE PLAN

PLANS SHOWN ARE FOR MARKETING PURPOSES ONLY, ALL DIMENSIONS ARE APPROXIMATE AND NOT TO SCALE, THEY ARE SUBJECT TO ERRORS AND INACCURACIES AND NO LIABILITY WILL BE ACCEPTED. INTERESTED PARTIES SHOULD MAKE THEIR OWN ENQUIRIES.

51 DORRIE CRESCENT, MONCRIEFF